

// Automatic Doors with Patented Door Latching



Up-and-Over Garage Doors

More Than Thirty Designs in Steel and Timber





The Original Hörmann Up-and-Over Garage Door

The Ultimate in Quality and Aesthetics

Everything speaks in favour of the original: quality and safety, aesthetics and convenience, and of course engineering excellence. Every Hörmann up-and-over door produced is the result of more than 50 years' experience in the building of garage doors. That's why Hörmann is Europe's No. 1 manufacturer of up-and-over garage doors. And the wide variety of styles means you're sure to find the perfect door to complement your home.

Contents



Ribbed Steel Garage Doors	4
Steel Door Versions	6
Panelled Steel Garage Doors	8
Doors with Solid Timber Infill	10
Design Doors with Solid Timber Infill	12
Open-for-infill Door	14
The Full Range of Steel Designs at a Glance	16
Glazing and Handles	22
Door Renovations	24
Renovating Ready-built Garages	26
Automatic Doors with Electric Operator	28
Safety Features	30
Door Sizes, Fitting Dimensions	32
Overview of Side and Wicket Doors	38

Some of the doors shown in this brochure have special features and therefore do not always represent the standard version.

Copyright. No part of this brochure may be reproduced without our permission. Subject to changes.

Certified brand quality with long-term guarantee

It goes without saying that Hörmann doors and operators are precisely matched and for your safety are tested by the TÜV (German Technical Inspectorate) and for compliance with the relevant standards.

Manufactured according to the Quality Management System DIN ISO 9001, **they already meet all the requirements of the European Standard 13241-1** (further details on pages 30-31).

* Terms and conditions of the guarantee, specifications and all further details on Hörmann up-and-over doors can be found on the Internet at www.hoermann.com.



Design 957 horizontally ribbed steel with centre and side profiles.



The Classic Designs in Steel

Horizontally or vertically ribbed

Timeless in appearance and always up-to-date. A ribbed infill is a firm favourite every time. Whether the steel ribs are arranged horizontally or vertically, accentuated by a horizontal or vertical frieze. What's more you have the possibility of lending your door its own distinct character: by adding a beautiful handle, selecting the colour of your choice or including light-transmitting windows.

Long-term protection to resist weathering

The galvanized material with high-grade powder-coating affords the best possible protection against corrosion. So you can be confident that your door will retain its good looks for many years to come.



Design 902 with integral wicket door, extremely practical when there is no space for a garage side door.



Design 941 ribbed steel with surface-mounted frieze, for double garages up to 5 m wide.



Design 902 vertically ribbed steel with matching side door.



Design 902 ribbed steel in the factory colour Terra brown.



Bring colour into play!

Garage doors don't always have to be white.

Information on the broad colour spectrum can be found on page 17.

Design 990 Ribbed steel, chevron style.
Seen here as a double garage door in an attractive chevron design.



The Interesting Steel Versions

Ribbed chevron-style steel, panelled infill or as a fully ventilated door

The chevron design infill is the ideal choice for garages with a matching gable roof and for homes in the country house style. The wide panelled infill is especially complementary to properties featuring contemporary architecture and clean distinct lines. The steel door with ventilation slots is particularly recommended for underground and collective garages.



Design 982 panelled steel.
As a double garage door to complement classic architecture.



Design 990 ribbed steel, chevron style.
Colour co-ordinated to complement the country house style.



Design 982 panelled steel.
In colour harmony with the entrance door.



Design 914 ribbed steel with ventilation slots.
As required by the relevant regulations for underground and collective garages.

The broad spectrum of special colours can be found on page 17.



A beautiful handle always provides a special highlight

Design 972 with matching side door in crisp-looking Traffic White (standard colour).



Attractive Steel Panels

Highly popular and fully in keeping with current trends

The panelled sections on the garage door and side door are perfectly aligned. This is an aspect that we attach great importance to. Because it produces perfect aesthetics – something that is often lacking on other panelled doors.



Design 976 with "cathedral-style" top panel to echo the style of the entrance door.



Design 978. An attractive arrangement of wide rectangular panels.



Design 974. An interesting look featuring panels of differing sizes.



Design 972 in a special blue colour, incorporating decorative cross windows to make the garage light and bright.

Coloured doors catch the eye. The full range of colours is shown on page 17.



Glazed panel sections as design and light-transmitting elements. Other designs on page 22.

Design 934 Nordic Pine as a double garage door with site-fitted fascia panel, in the style of the gable cladding.



The Beauty of Nature

Solid timber infills in exquisite quality

If timber determines the appearance of your home, then opting for a garage door in solid timber is the logical choice. Hörmann offers you a range of twelve different designs: vertically or horizontally boarded, in a chevron or rhombus style. We use carefully selected, superior quality timber profiles of Nordic Pine which we have pretreated using a colourless wood preservative – the best protection against insect and fungal attack.



Design 924 Nordic Pine, one of three designs featuring horizontal boarding.



Design 922 Nordic Pine with triangular glazing, integrated into the rhombus design.



Design 931 Nordic Pine, chevron-style boarding with individual wood stain coating.



Design 934 Nordic Pine, vertical boarding, matching the entrance door.

Wood needs protecting

That's why in addition to the impregnation provided at the factory, it is important for you to apply a pigmented wood preservative to your timber garage door to protect it against atmospheric influences and the effects of UV rays.

In the process you can paint the naturally light-coloured softwood according to your own colour scheme to blend in with the timber elements of your property.

You will find instructions on the site treatment and painting of timber in our fitting manual.

An overview of all 12 timber designs is provided on pages 18 and 19.

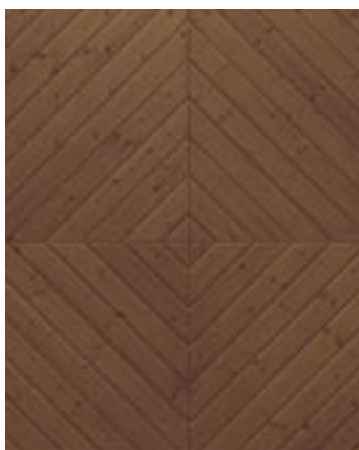

When you subsequently treat your timber door - an essential measure to protect it from UV rays - you can also use another wood preservative, such as teak finish.



The Exclusive Design-Line Timber Doors

Also in the partner look with entrance doors

With Hörmann's Design Line you stamp your own personal mark on your house and garage, thereby setting your property apart from the rest. Thanks to the many design variants with stylishly arranged elements, these Design doors are guaranteed to catch the eye, particularly when combined with Hörmann Design entrance doors.

Garage Door and Aluminium Entrance Door with Stylish Stainless Steel Embellishments

If up until now the entrance door was your home's sole "visiting card", you can now afford your garage door the very same status. Be inspired by the beautiful designs and the myriad of options available to you.



Garage door design 689



Entrance door design 689 A



Garage door design 22



Entrance door design 22 AF



Garage door design 45



Entrance door design 45 A

The door leaves comprise a highly rigid multi-layer timber infill which is finished with a triple silky matt coating in Pure White. The door frame is already primed white at the Hörmann factory.

Further designs can be found on pages 20-21, in the special Hörmann brochures "Design Garage Doors" and "Hörmann Entrance Doors" as well as on the Internet at [www. hoermann.com](http://www.hoermann.com).



Design garage doors of course with operator

Design and convenience are the distinguishing features of these exclusive garage doors. That's why they are equipped as standard with Hörmann's SupraMatic E operator in a sleek stainless steel casing.

This is the Solid Basis

- Extremely sturdy frame construction with reinforced struts Fully welded!
- Fully galvanized, door leaf frame additionally primed with a high-grade powder coating in Terra Brown colour (similar to RAL 8028).
- Frame and struts predrilled at 30 mm spacings.
- Illustrated fitting instructions with suggested designs

Infill weight

Depending on the door size, between 6 and 10 kg/m²
Doors for double garages up to a maximum of 16 kg/m²
See also page 33.



It's fun to be hands on and watch your own ideas take shape.



Design Your Own Door

We provide the solid basis

Applying the timber boarding couldn't be easier. Because Hörmann supplies the frame and struts predrilled at 30 mm spacings. Give free rein to your creative talent: regardless of whether the timber boarding is arranged vertically, horizontally or according to your own design. You can proudly show off your own creation.

You have full creative freedom.



This door construction offers you two design options:

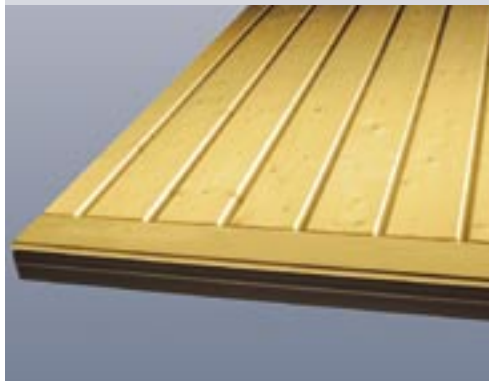

Infill overlapping the frame, whereby the frame and bottom section are entirely concealed.

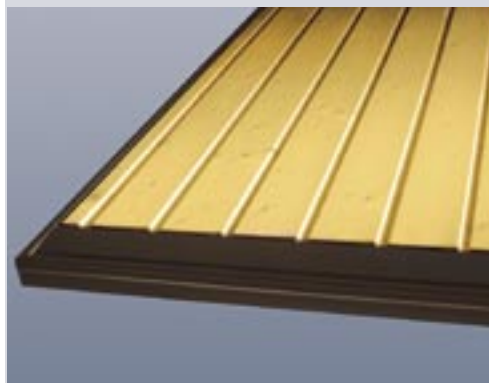

Timber infill within the frame with visible bottom section to protect against spray water.

Advice on site treatment

Once fitted, it is essential that you treat your door with a proprietary pigmented wood preservative to protect it against UV rays as well as fungal and insect attack.

The Full Range of Steel Designs at a Glance



902 Vertically ribbed steel ●



914 Ribbed steel with ventilation slots ●



941 Ribbed steel with surface-mounted frieze ●

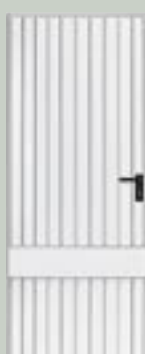

982 Panelled steel ●



957 Ribbed steel with centre profile / side profiles ●



990 Ribbed steel, chevron style ●



Irrespective of the colour, primed with a high-grade powder-coating

The galvanized door leaves are protected against corrosion and the adverse effects of the environment right into the cut edges. Garage doors and side doors are available as standard in the inexpensively priced colours White and Brown, in a choice of 10 equally priced factory colours, as well as in around 200 colours from the RAL colour chart. Pearl-effect, luminous and metallic colours are excluded.





970 Panelled steel



972 Panelled steel



974 Panelled steel



976 Panelled steel



978 Panelled steel

All designs as door type N80 up to 3000 mm wide.

- We also supply these designs as the DF 98 door type for double garages up to 5000 mm wide.

Designs 902 and 914 are also available with integral, outwards opening wicket door.

All side doors can also be obtained as double-leaf versions.

**10 factory colours, one price.
Competitively priced White and Brown.**

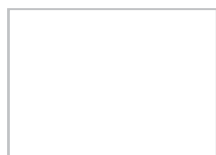

Traffic white, RAL 9016



Ruby red, RAL 3003



Dove blue, RAL 5014



Fir green, RAL 6009



Window grey, RAL 7040



Terra brown, RAL 8028



Light ivory, RAL 1015

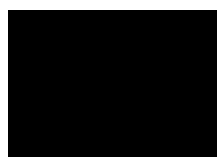

Sapphire blue, RAL 5003



Moss green, RAL 6005



Stone grey, RAL 7030



Ochre brown, RAL 8001



White aluminium, RAL 9006

All colours based on RAL Generally outside and inside in the same colour.

The Full Range of Solid Timber Designs at a Glance

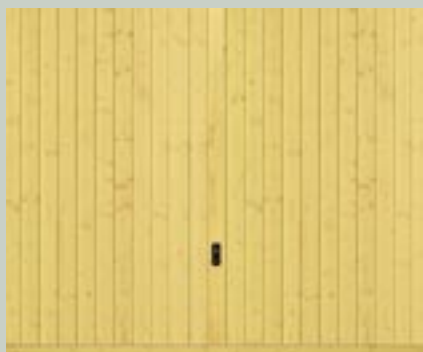

923 Nordic Pine



934 Nordic Pine



924 Nordic Pine

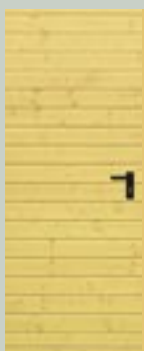

933 Nordic Pine

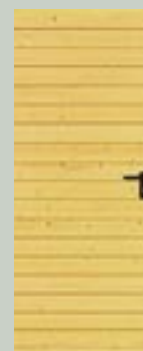

926 Nordic Pine

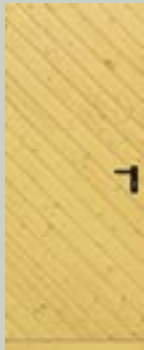

931 Nordic Pine



All timber infill doors are supplied foil-wrapped to protect them during transit and site storage.

Softline-Design because it looks so much better!

That's why all the timber boards (120 x 14 mm) are softly rounded.

This is what makes the timber designs so aesthetically appealing.



935 Hemlock

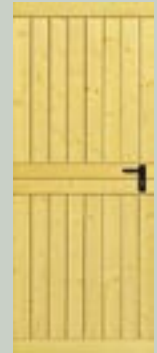

937 Nordic Pine



930 Nordic Pine

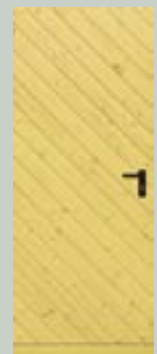

925 Nordic Pine

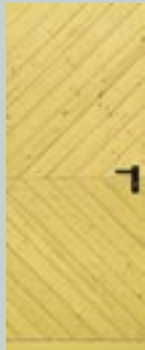

927 Nordic Pine



922 Nordic Pine



905 Open-for-infill



also double-leaf

All designs as the N80 door type up to 3000 mm wide.

- We also supply these designs as the DF 98 door type for double garages up to 5000 mm wide.
- Infill overlapping the frame including frame
- Designs with the timber infill within the frame

The Full Range of Design-Line Timber Doors at a Glance

Designs with finished multi-layer timber infill

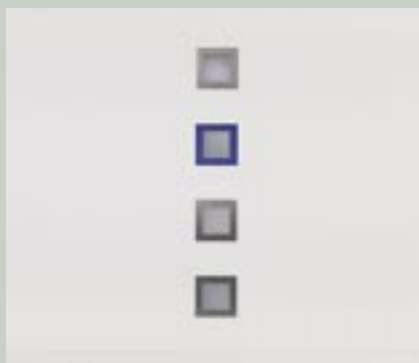

Design 175
Smooth timber infill
single-pane safety glass
Pave white
With glazing frame in blue painted stainless steel.
All the RAL colours are possible.



Design 62
Smooth timber infill
Single pane safety glass
white with glazing frame and
flush-fitting bottom strip in
brushed stainless steel.

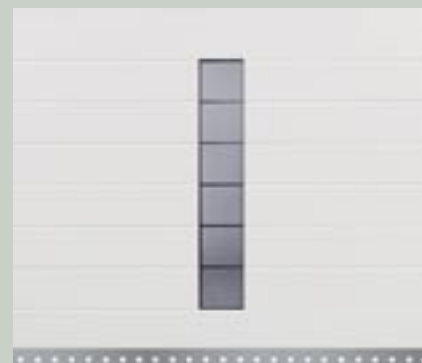

Design 689
Smooth timber infill
with horizontal grooves,
single-pane safety glass
Parsol grey sandblasted
with clear, horizontal stripes
and flush-fitting stainless steel bottom strip.

Thanks to the many design variations with stylishly arranged elements in stainless steel and glass, Hörmann Design-Line doors become an attractive focal point and an expression of your impeccably good taste.

Designs with finished profile boards in Nordic Pine



Design 917
with vertical boarding and
flush-fitting coloured and stainless steel
embellishments.

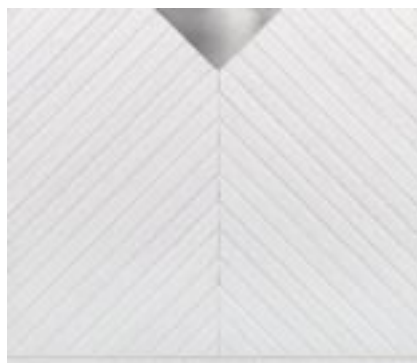

Design 918
With chevron-design boarding and
flush-fitting embellishments in brushed
stainless steel.

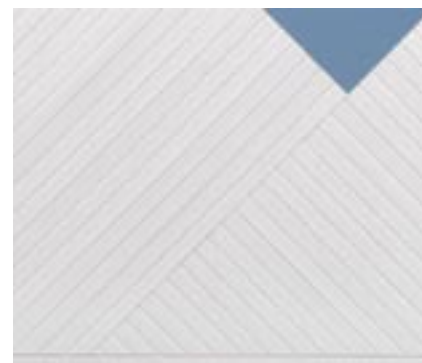

Design 919
with diagonal profiling
and flush-fitting coloured embellishments.



Design 22
Smooth timber infill with horizontal grooves, stainless steel embellishments with blue-painted stripes, perforated arched element brushed stainless steel, single-pane safety glass Parsol grey.



Design 41
Smooth timber infill Large curvaceous embellishments in brushed stainless steel, single-pane safety glass Parsol grey, sandblasted with clear edge.



Design 43
Smooth timber infill Large arched embellishment in blue-painted aluminium, single-pane safety glass Masterpoint.



Design 45
Smooth timber infill Single-pane safety glass Parsol grey, sandblasted with clear, horizontal stripes, glazing frame and bottom strip in brushed stainless steel.

For these 7 Design garage doors we have selected highly stable multilayer timber infills. Finished with a triple coating of pure white silky-matt paint, the surface is light-fast and weather-resistant. The garage door frame is powder-coated with a white primer.

Door sizes
Width up to 3000 mm
Height up to 2250 mm

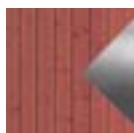

For the garage door leaf any combination of colours and embellishments can be chosen.

Besides producing a silky-matt sheen, three coats of paint make the surface light-fast and weather-resistant. So you can be confident that the doors will retain their good looks for many years to come. The garage door frame is powder-coated with a primer: White for white and coloured garage doors, Terra Brown for stained timber doors.

Door sizes
Width up to 3000 mm
Height up to 2500 mm

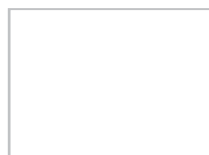

Pure white



Pine yellow



Royal blue



Dove blue



Fir green



Light grey

Generally outside and inside in the same colour. Timber stains are also possible.



Figure 4: 283 x 203 mm



Figure 5: 283 x 203 mm



Figure 6: 283 x 203 mm

Glazing in steel infills

Available for the designs 902, 941, 957, 972 and 982.

Material: weather-resistant plastic. Colour: Tone-in-tone with the colour of the garage door leaf. Glazing: 3 mm plastic panes, clear or crystal structure.

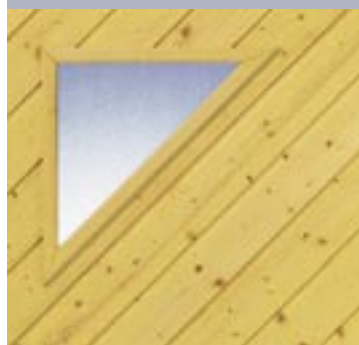

Figure 21: 375 x 375 mm



Figure 22: 235 x 235 mm



Figure 23: 277 x 199 mm



Figure 24: 199 x 277 mm

Glazing in timber infills

Figures 21 and 22 for the designs: 922, 925, 926, 927 and 931.

Figures 23 and 24 for the designs: 923, 924, 930, 933, 934, 935 and 937.

Material: timber, glazing: 3 mm. plastic panes, clear or crystal structure.

Let Your Garage See the Light of Day !

Glazing is more than just a design feature, it also saves you having to build an additional window in your garage.

Taking advantage of daylight means you can also use your garage as a workshop.

Side doors are available with a round handle set in all the materials shown. As standard with lever handles on both sides or on request with lever/knob handle set.



Black plastic as standard



Cast aluminium (similar to RAL 9016)



Cast aluminium, new silver finish



Cast aluminium, brass finish



Polished stainless steel



Brushed stainless steel



Cast aluminium, rustic style



Cast aluminium, bronze finish

The flush-fitting cylinder lock can also be mastered with other locks in your home.



Beautiful Handles Add Value to Your Door

The garage door handle developed by designers and security experts is unique in its shape.

Thanks to the ergonomic styling you always have a secure, comfortable grip.



Out with the Old - in with the New

Quick and clean and all on the same day

»We're delighted that everything has gone so well. The new garage door blends in much better with the style of the house and the old garage door was disposed of at the same time. Our only regret is that we didn't invest in an electric operator years ago!«



Fascia panels and renovation panels

In the case of renovations, the structural opening can sometimes be higher and wider than the more inexpensively-priced standard-sized garage door. Hörmann solves this problem by offering aesthetically-pleasing top and side fascia panels to close the gaps. If masonry is damaged on removing the old garage door, a renovation panel provides a neat solution without the need for any further plastering.



Bottom rubber seal for an unbroken flat floor line

The flexible weather-proof rubber seal helps keep out leaves, driving rain, hail and snow.



Extras for improved acoustic and thermal insulation

Order your door with a special Dämmtec coating to provide good acoustic insulation right from the start. To improve the thermal insulation value, we can supply thermal insulation boards which you simply clip onto the inside of the garage door or you can have them prefitted at the factory.



Three-point security latching

As a DIY retrofit kit for all non power-driven up-and-over doors. It provides greater security to prevent your garage door from being forced open.



Stainless steel weather bar

Where garages face the elements, we recommend using a stainless steel threshold rail to ensure the bottom of the garage door remains free from rust for decades to come.



Hörmann N80 and F80 Up-and-Over Doors

Ideal for renovating ready-built garages and series garages

There will come a point when you just can't face painting the old garage door any more, not to mention the daily inconvenience of having to open a hinged-leaf door.

It's then worthwhile investing in a new Hörmann up-and-over door in one of the many competitively priced standard sizes. The door comes with a weather-resistant powder coating, looks good and is much easier to open too.



Renovating ready-built garages using competitively priced standard sizes

- Quick and clean replacement of the garage door within the day
- 3 fitting methods to cover every installation situation
- Old doors are disposed of at the same time

Our recommendation for greater security: the retrofit kit for triple locking (see page 25).

Door sizes and fitting dimensions on pages 32, 34 and 37.

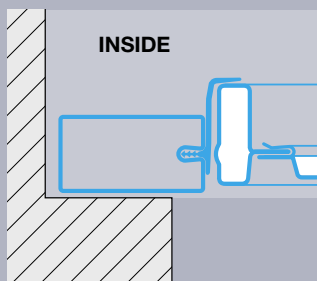

Door type N80
Fitting behind the structural opening

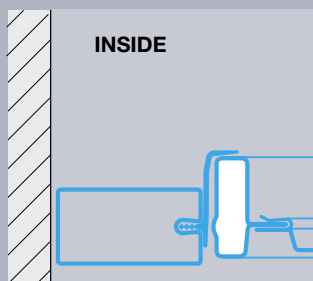

Door type N80
Fitting in the structural opening

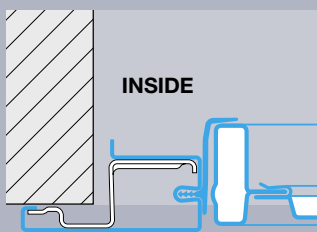

Door type F80
Fitting in front of the structural opening

Depending on the space available, these three fitting methods are possible for renovations.

Best with an operator right from the start

Opening your garage door then becomes much more convenient and the automatic door latching makes it more secure against being forced open.

The track-guided automatic up-and-over garage doors just keep running and running ...



Hörmann Automatic Up-and-Over Doors

because they offer greater convenience and security

You can operate a Hörmann automatic door as conveniently as your TV set. On the press of a button, you drive into your garage, protected from all weathers. When it's dark, the direct route affords you greater safety and security. It goes without saying that Hörmann doors and operators are tested by the TÜV (German Technical Inspectorate) as a single safety unit.

Choose between these two innovative Hörmann operators



ProMatic (EcoMatic)



The competitively-priced operator with an elegant, slate grey plastic cover

For garage doors with a maximum surface area up to 10 sqm or width up to 5000 mm.
For 2 parking spaces.
Push and pull force: 500 N

Two-button hand transmitter included as a standard feature of both operators.



SupraMatic



The powerful operator with the elegant stainless steel cover and a host of additional functions.

For all garage doors up to 5500 mm wide, including heavy timber doors and garage doors with wicket pass door.
For garages with up to 5 parking spaces.
Push and pull force:
SupraMatic E 550 N
SupraMatic P 600 N

The Operator Technology

- 868.3 MHz radio frequency with a stable range ✓
- Hand transmitter with security code from more than 1 billion options ✓
- Automatic door latching affords effective protection against forced opening. ✓
- On encountering an obstruction, a reliable automatic cut-out stops the door immediately ✓
- "A soft" start and "soft" stop saves wear and tear on both the door and operator ✓
- Maintenance-free patented toothed belt. ✓
- Internal emergency release ✓
- Easy to install. Everything is precisely prepared. ✓

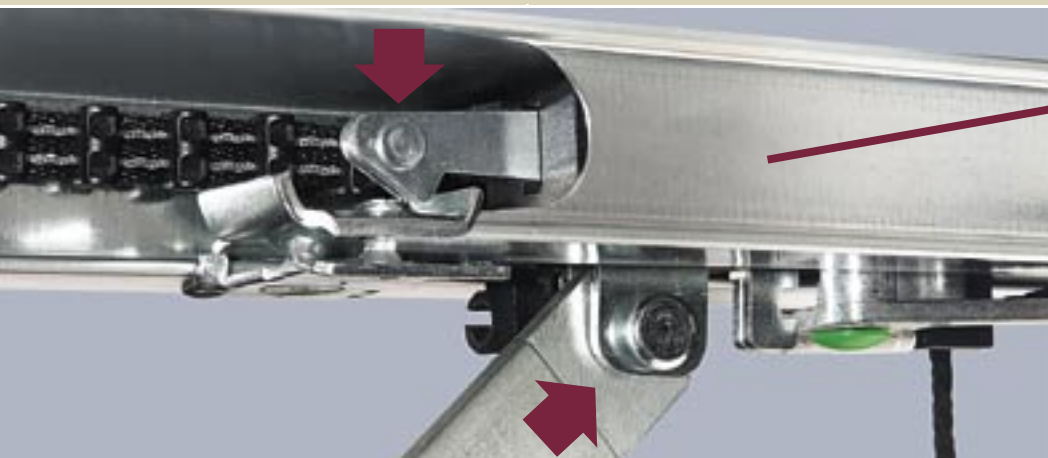

Door latching in the operator boom – a Hörmann patent



...with Automatic Door Latching

The operator system latches the door

The door automatically latches on closing, making it impossible to lever it open. This unique automatic latching system is a mechanical device, so remains fully functional even in the event of a power failure.



Further information on Hörmann operators for garage doors and entrance gates can be found in our specialist brochures or on our website at www.hoermann.com.

Safety Features to the European Standard 13241-1 in Force from 1st May 2005

Assured quality

Hörmann up-and-over doors are already tested and certified according to the high safety requirements and performance characteristics of the European Standard 13241-1.

This gives you the reassurance that your purchase of a Hörmann up-and-over door is a safe investment.

It's worth making a comparison



The door cannot crash to the floor!

That's something you can be absolutely sure of.

- 1 Multiple spring safety system**
In the event that one of the springs should break, the others safeguard the door. A broken spring cannot fly off into the air.
- 2 Precision track guidance**
prevents the door leaf from "derailing".
- 3 Unique track well**
Once fully opened, the door is gently cushioned and always brought to a safe, reliable halt in the track well.

No trapped fingers!

Comprehensive finger-trap protection.

- 4 Protective caps over the lifting arms**
Flexible plastic caps protect the entire joint area, so there's no risk of trapped fingers.
- 5 Protective profiles on door leaf and frame**
Flexible plastic profiles down the sides act as reliable side trap guards between the door leaf and frame. Double garages have a flexible seal at the bottom to provide foot trap protection.
- 6 Safety distance between springs**
The distance between the spring windings is so small that even children's fingers are reliably protected.

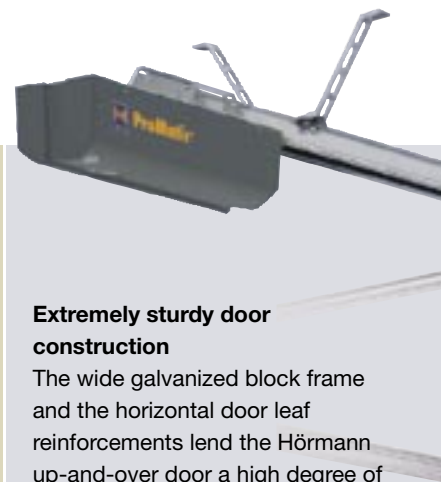

Extremely sturdy door construction

The wide galvanized block frame and the horizontal door leaf reinforcements lend the Hörmann up-and-over door a high degree of stability.

A smooth, quiet door action

Everything is perfectly matched: the 4-point suspension, the precision track guidance, the smooth-running plastic rollers, the plastic profiles down the sides (no steel on steel contact) and the adjustable spring assemblies.

Lock with two-fold benefit

If the house is entered directly from the garage, the garage door can also be locked from the inside using a security pin. The lock can be integrated into the building's master locking system.

Well protected from all weathers

As standard via the bottom threshold rail and where there is an unbroken flat floor line, on request with weather-proof rubber bottom profile (see page 25).

Maximum Personal Safety

It's reassuring to know that the door comes with extensive safeguards

Hörmann up-and-over doors incorporate reliable safeguards to eliminate trap zones and prevent the door leaf from crashing to the floor. There could hardly be a more safer up-and-over door. And in terms of security, the latching systems ensure that you are always on the safe side. Irrespective of whether you opt for an automatic door or a manually operated door.

Complete with fixings and infinitely adjustable universal anchors, installation couldn't be easier.

The door comes to a safe halt in the track well.



Burglar-resistant latching

Adjustable latches effectively lock the manually operated door at each bottom corner. On request a retrofit kit allows you to fit an additional latch at the top to provide 3-point latching (see page 25).



Multiple spring safety system

With optimally dimensioned adjustable spring assemblies depending on the door size and door weight: N80 door type: 3-4 springs per side, DF98 door type: 6-10 springs per side.

Door Sizes

Door types N 80 and DF 98

N80 standard sizes for single garages (depending on door design)								Dimensions in mm			
Ordering size		Overall frame size		Clear passage dimensions*		Fitting behind the opening				Fitting in the opening	
						Fitting area Structural dim.	Recommended structural dim.	Fitting area Structural dim.	Recommended structural dim.	Structural dim.	
Width	Height	Width	Height	Width	Height	Width		Height		Width	Height
2250	1920	2355	1990	2110	1800	2240 (2210-2335)		1915 (1890-1950)		2375	1970
2250	2000	2355	2070	2110	1880	2240 (2210-2335)		1995 (1970-2030)		2375	2050
2250	2075	2355	2145	2110	1955	2240 (2210-2335)		2070 (2045-2150)		2375	2125
2250	2125	2355	2195	2110	2005	2240 (2210-2335)		2120 (2095-2155)		2375	2175
2375	1920	2480	1990	2235	1800	2365 (2335-2460)		1915 (1890-1950)		2500	1970
2375	2000	2480	2070	2235	1880	2365 (2335-2460)		1995 (1970-2030)		2500	2050
2375	2075	2480	2145	2235	1955	2365 (2335-2460)		2070 (2045-2105)		2500	2125
2375	2125	2480	2195	2235	2005	2365 (2335-2460)		2120 (2095-2155)		2500	2175
2375	2250	2480	2320	2235	2130	2365 (2335-2460)		2245 (2220-2280)		2500	2300
2375	2375	2480	2445	2235	2255	2365 (2335-2460)		2370 (2345-2405)		2500	2425
2500	1920	2605	1990	2360	1800	2490 (2460-2585)		1915 (1890-1950)		2625	1970
2500	2000	2605	2070	2360	1880	2490 (2460-2585)		1995 (1970-2030)		2625	2050
2500	2075	2605	2145	2360	1955	2490 (2460-2585)		2070 (2045-2105)		2625	2125
2500	2125	2605	2195	2360	2005	2490 (2460-2585)		2120 (2095-2155)		2625	2175
2500	2250	2605	2320	2360	2130	2490 (2460-2585)		2245 (2220-2280)		2625	2300
2500	2375	2605	2445	2360	2255	2490 (2460-2585)		2370 (2345-2405)		2625	2425
2500	2500	2605	2570	2360	2380	2490 (2460-2585)		2495 (2470-2530)		2625	2550
2500	2750	2605	2820	2360	2630	2490 (2460-2585)		2745 (2720-2780)		2625	2800
2625	2125	2730	2195	2485	2005	2615 (2585-2710)		2120 (2095-2155)		2750	2175
2750	2000	2855	2070	2610	1880	2740 (2710-2835)		1995 (1970-2030)		2875	2050
2750	2125	2855	2195	2610	2005	2740 (2710-2835)		2120 (2095-2155)		2875	2175
3000	2000	3105	2070	2860	1880	2990 (2960-3085)		1995 (1970-2030)		3125	2050
3000	2125	3105	2195	2860	2005	2990 (2960-3085)		2120 (2095-2155)		3125	2175

DF 98 standard sizes for double garages (depending on door design)								Dimensions in mm			
Ordering size		Overall frame size		Clear passage dimensions*		Fitting behind the opening				Fitting in the opening	
						Fitting area Structural dim.	Recommended structural dim.	Fitting area Structural dim.	Recommended structural dim.	Structural dim.	
Width	Height	Width	Height	Width	Height	Width		Height		Width	Height
4000	2000	4096	2073	3840	1820	3990 (3950-4070)		1995 (1960-2020)		4116	2043
4000	2125	4096	2198	3840	1945	3990 (3950-4070)		2120 (2085-2145)		4116	2168
4500	2000	4596	2073	4340	1820	4490 (4450-4570)		1995 (1960-2020)		4616	2043
4500	2125	4596	2198	4340	1945	4490 (4450-4570)		2120 (2085-2145)		4616	2168
4500	2250	4596	2323	4340	2070	4490 (4450-4570)		2245 (2210-2270)		4616	2293
5000	2000	5096	2073	4840	1820	4990 (4950-5070)		1995 (1960-2020)		5116	2043
5000	2125	5096	2198	4840	1945	4990 (4950-5070)		2120 (2085-2145)		5116	2168

Please note

* Clear passage dimensions (door with stepped floor)

Width: ordering size minus 140 mm (160 mm for DF 98 door)

Height: ordering size minus 120 mm (180 mm for DF 98 door)

Height: ordering size minus 135 mm for design 905 (200 mm for DF 98 door)

Height: 25 mm more passage (with flat floor)

Door Sizes

Door types N 80 and DF 98

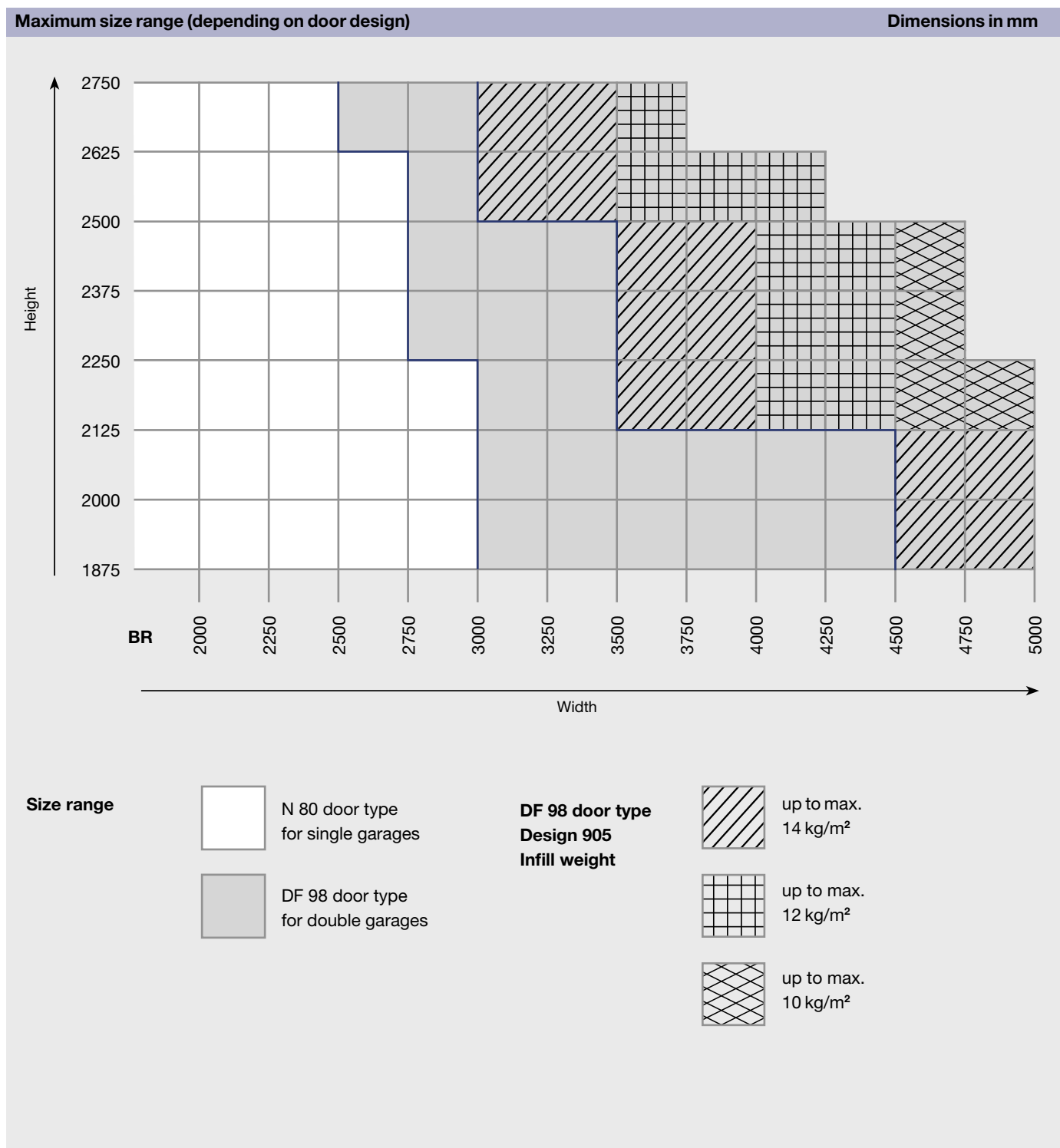

Doors with renovation panel **Open-for-infill doors (design 905)**

The recommended structural width may not be exceeded. In the case of a stepped floor, the recommended structural height may not be exceeded by more than 10 mm. For garage doors with a finished flat floor line (frame at FFL), 30 mm should be added to the recommended structural height.

Please note the maximum weight for site infills, which, depending on the door size, ranges between 6 and 10 kg/m². Depending on their size, DF 98 doors are also available with an infill weight of up to 16 kg/m² (exception: doors within the shaded area above). Consult your Hörmann specialist dealer who will be able to tell you the exact infill weight per m² for your particular door.

Fitting Dimensions

Door type N 80 for single garages

Position of anchors

Dimensions in mm

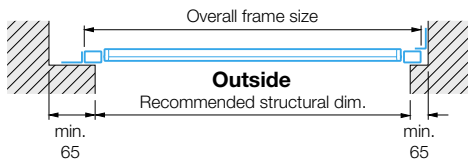
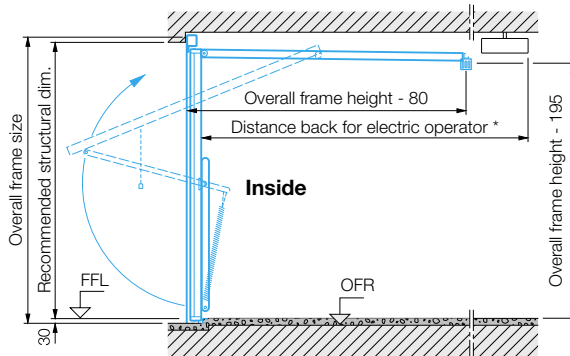
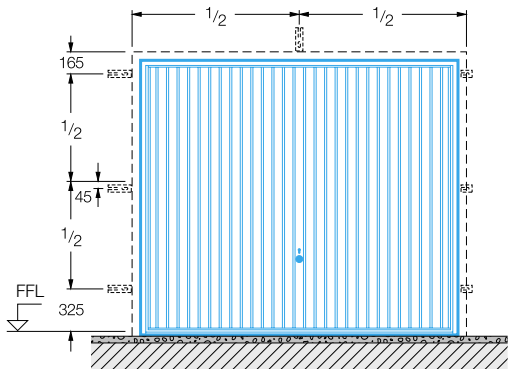

* Distance back for electric operators:
 3100 mm up to door height 2375 mm ProMatic / SupraMatic
 3350 mm up to door height 2625 mm ProMatic / SupraMatic
 4100 mm up to door height 2750 mm ProMatic / SupraMatic

Fitting behind the opening

Door with stepped floor

Door with flat floor

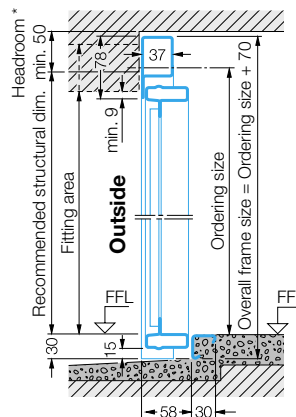
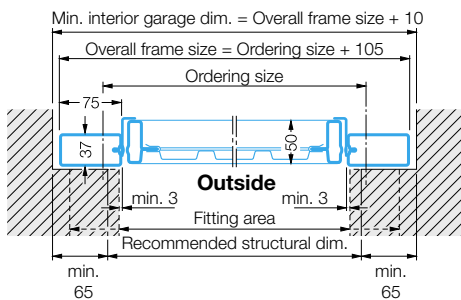

The structural height recommended in the table (page 32) must be increased by 25 mm.

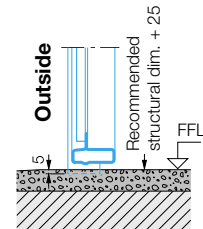

The recommended structural dimensions are recommended planning dimensions. Minimum sideroom, headroom and opening sizes are all based on these dimensions.

With ProMatic/SupraMatic operator

* No additional headroom required.

Exception: Designs 905, 941, designs with timber infill = 15 mm clearance.

Fitting in the opening

Door with stepped floor

Door with flat floor

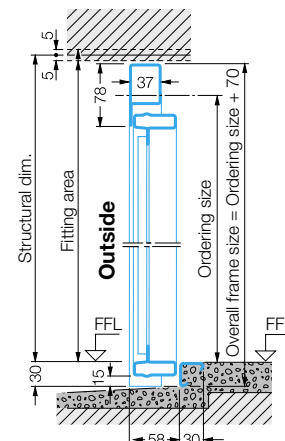
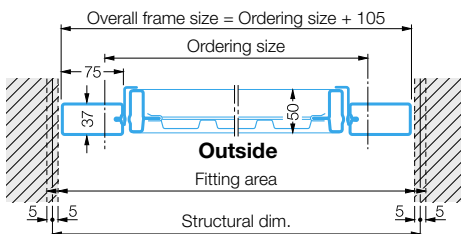

The structural height stated in the table (page 32) must be increased by 25 mm.

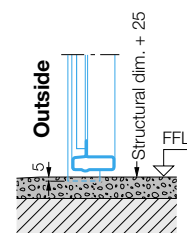

Fitting in the opening requires that the given dimensions be adhered to with greater accuracy, particularly where standard-sized doors are concerned. Special-sized doors are purpose-built for the existing structural opening.

With ProMatic/SupraMatic operator

No additional headroom required.

Exception: designs 905, 941, designs with timber infill = 15 mm clearance.

Fitting Dimensions

Door type DF 98 for double garages

Position of anchors Dimensions in mm

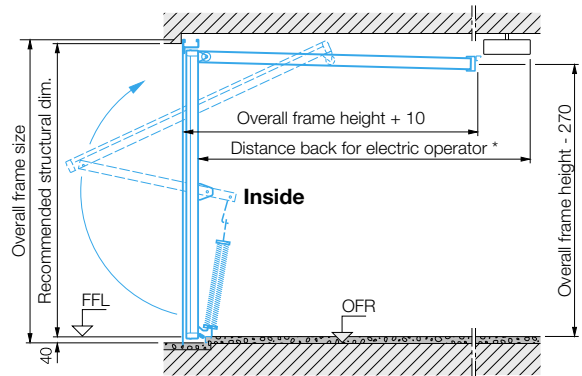
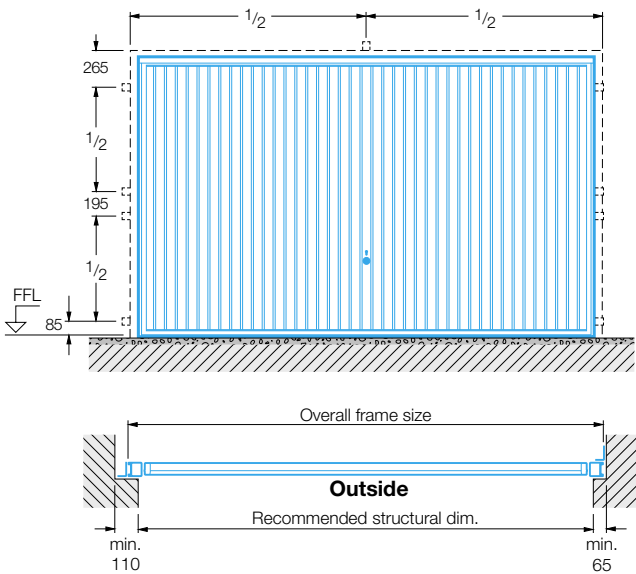

* Distance back for electric operators:
 3100 mm up to door height 2375 mm ProMatic / SupraMatic
 3350 mm up to door height 2625 mm ProMatic / SupraMatic
 4100 mm up to door height 2750 mm ProMatic / SupraMatic

Fitting behind the opening Door with stepped floor Door with flat floor

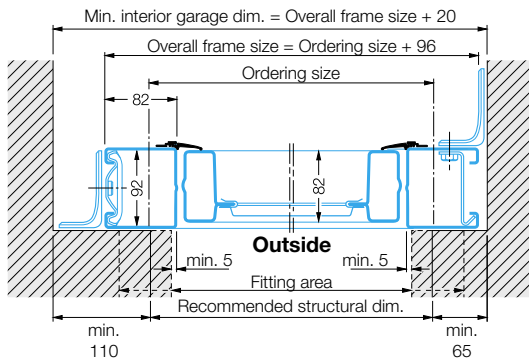

The recommended structural dimensions are recommended planning dimensions. Minimum sideroom, headroom and opening sizes are all based on these dimensions. Note for standard sizes: if the sideroom lies in the 65 mm to 110 mm range, this must be stated on the order.

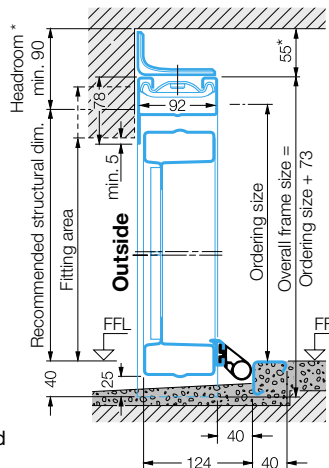

The structural height recommended in the table (page 32) must be increased by 25 mm.

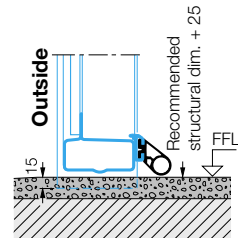

With ProMatic/SupraMatic operator * 65 mm clearance

Fitting in the opening Door with stepped floor Door with flat floor

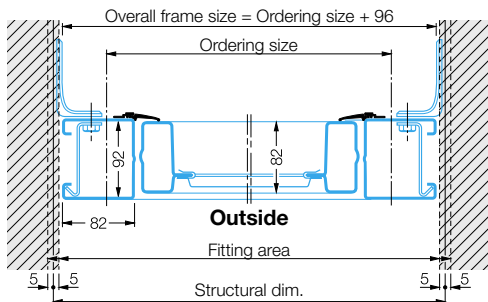

Fitting in the opening requires that the given dimensions be adhered to with greater accuracy, particularly where standard-sized doors are concerned. Special-sized doors are purpose-built for the existing structural opening.

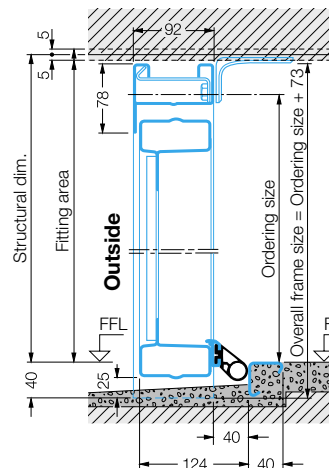

The structural height recommended in the table (page 32) must be increased by 25 mm.

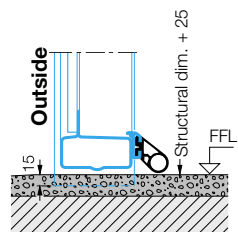

With ProMatic/SupraMatic operator 65 mm clearance

Sizes and Fitting Dimensions

Garage side doors

Single-leaf / Position of anchors Door with flat floor Door with stepped floor Dimensions in m

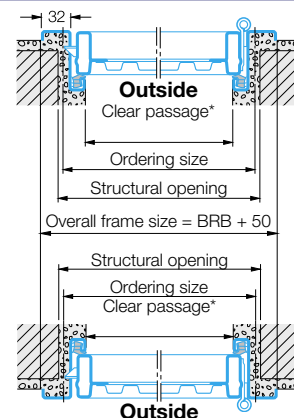
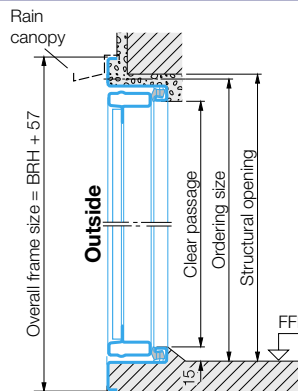
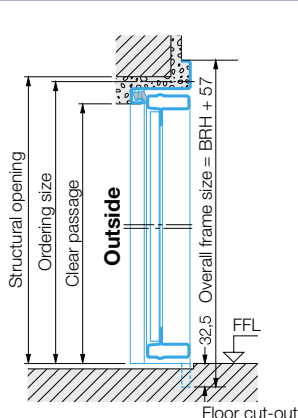
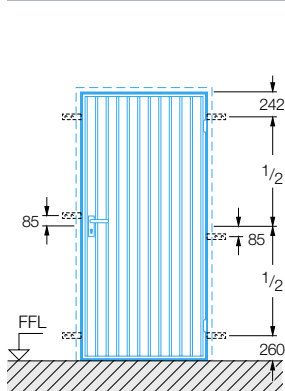

Standard sizes for single-leaf doors

Ordering size		Structural opening		Clear passage*		Handle Height from FFL
Width	Height	Width	Height	Door with flat floor Height	Door with stepped floor Height	
875	1875	885	1880	830	1840	990
875	2000	885	2005	830	1965	1050
875	2125	885	2130	830	2090	1110
1000	2000	1010	2005	955	1965	1050
1000	2125	1010	2130	955	2090	1110

For doors with a stepped floor, opening outwards, the ordering height is always measured from the finished floor line of the deeper floor.

* With an opening angle of less than 170°, the clear passage width is reduced.

Standard sizes with steel infill and for site infill are supplied as standard for internal fitting (opening inwards). By reversing the fittings, the doors can be converted to external fitting (opening outwards). Designs with timber infill only possible for external fitting.

Block frame for fitting into the opening: dimensions and versions on request.

Special sizes and special versions on request. Maximum size range (BR): 1250 x 2375 mm

Designs 902 and 905 in standard sizes can be LH or RH hinged.

Double-leaf / Position of anchors Door with flat floor Door with stepped floor

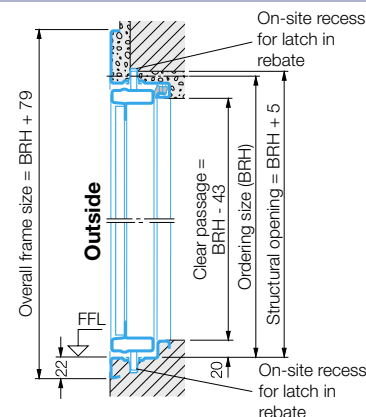
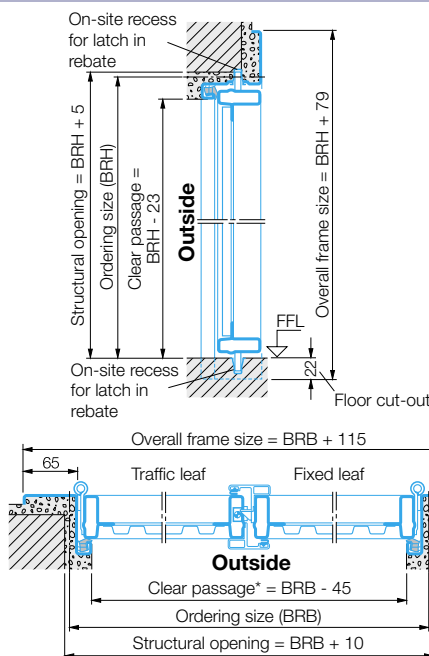
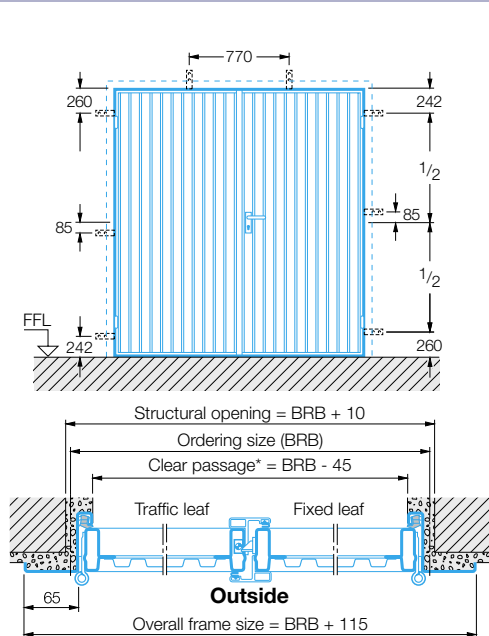

Size range for double-leaf doors

Width (ordering size): 1300 to 2500 mm
 Height (ordering size): 1750 to 2250 mm
 Panel designs only up to ordering width = 2000 mm

* With an opening angle of less than 170°, the clear passage width is reduced.

Block frame for fitting into the opening: dimensions and versions on request.

Supplied as standard for external fitting (opening outwards), traffic leaf on right. If internal fitting (opening inwards) or traffic leaf on left required, state on order!

Fitting versions



Internal fitting

For internally fitted doors, the threshold angle/transport angle should always be removed. Adequate water drainage to the outside must then be ensured. For doors on the weather side, external fitting is preferable.

External fitting

With threshold profile.

Renovation Sizes and Fitting Dimensions

F80 door type for ready-built garages

Door sizes for concrete garages with an externally fitted door			Dimensions in mm
Ordering size Width x height	Structural opening Width x height	Overall frame size	Clear passage Width x height
2375 x 2045	2449 - 2489 x 2088 - 2108	2509 x 2148	2235 x 1905
2375 x 2075	2449 - 2489 x 2118 - 2138	2509 x 2178	2235 x 1935
2425 x 2075	2499 - 2539 x 2118 - 2138	2559 x 2178	2285 x 1935
2485 x 2045	2559 - 2599 x 2088 - 2108	2619 x 2148	2345 x 1905
2500 x 2075	2574 - 2614 x 2118 - 2138	2634 x 2178	2360 x 1935
2500 x 2100	2574 - 2614 x 2143 - 2163	2634 x 2203	2360 x 1960
2560 x 2125	2634 - 2674 x 2168 - 2188	2694 x 2228	2420 x 1985
2570 x 2125	2644 - 2684 x 2168 - 2138	2704 x 2228	2430 x 1985
2590 x 2075	2664 - 2704 x 2118 - 2138	2724 x 2178	2450 x 1935
2590 x 2125	2664 - 2704 x 2168 - 2188	2724 x 2228	2450 x 1985
2705 x 2125	2779 - 2819 x 2168 - 2188	2839 x 2228	2565 x 1985
2715 x 2075	2789 - 2829 x 2118 - 2138	2849 x 2178	2575 x 1935
2720 x 2200	2794 - 2834 x 2243 - 2263	2854 x 2303	2580 x 2060
2730 x 2125	2804 - 2844 x 2168 - 2188	2864 x 2228	2590 x 1985

Door sizes for standard-sized garages in the former East German states			Dimensions in mm
2325 x 1905	2420 x 1990	2459 x 2008	2185 x 1765
2455 x 1905	2550 x 1990	2589 x 2008	2315 x 1765
2350 x 1935	2410 - 2450 x 1970 - 2005	2484 x 2038	2210 x 1795
2480 x 1935	2540 - 2580 x 1970 - 2005	2614 x 2038	2340 x 1795

Position of anchors

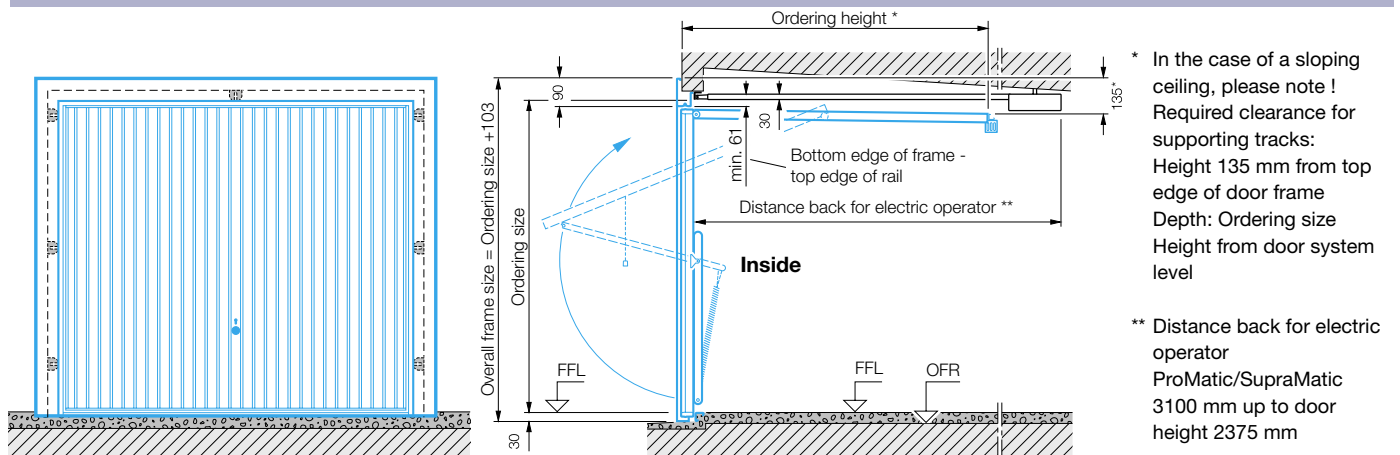

Building structure with/without plaster framing

Plug-and-screw fixing from 75 mm reveal depth

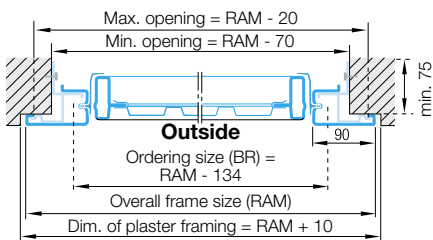

Clamping at least 50 mm, max. 100 mm reveal depth

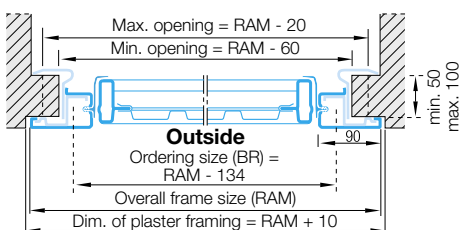

with stepped floor

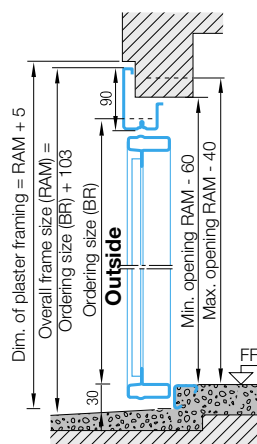

with flat floor

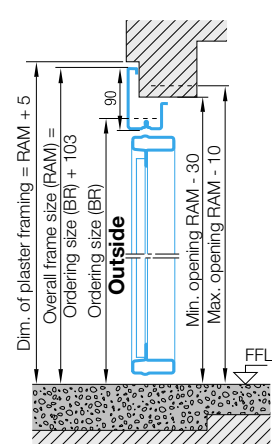

Improved Aesthetics Added Convenience Increased Security

Hörmann Quality Doors

To make the basement entrance secure, for wet rooms, the hobby room, a child's or teenager's bedroom, the converted loft, boiler room or as a door connecting the garage with the rest of the house.

The wide range means that a more economically-priced standard size will nearly always fit. Costly specials are not necessary. This saves you money!

Find out more about Hörmann's wide range of beautiful TopComfort entrance doors and canopies. Request our brochures or visit us on the Internet at www.hoermann.com.



KS*i* security door

As a burglar-retarding steel door with multiple locking as standard. For the entrance to the basement, as a side door or for the garage.

MZ multi-purpose door

The sturdy steel door, also with insulating glazing. For basement rooms, outbuildings, equipment sheds, barns.

The HA30 fire-retarding door

The tested fire-retarding steel door. The ideal door for connecting the garage with the rest of the home.



Doors for All Areas of the Home



The door for the non-domestic building sector

The sturdy steel door leaf to meet the most exacting standards.

ZK internal door

The decorative steel doors for all areas of the home, from the basement right up to the attic. In an array of colours, timber designs, glazings and equipment.

Steel frame

The slot-screw or welded standard frames that you can easily fit yourself, e.g. for the loft conversion.

